

Aluminium Window & Door Systems

aluk.co.uk

Experts in Aluminium

ALUK[®]



Contents

5 By experts	24 Door Systems
6 Why choose aluminium?	26 Luminia 58BD Flush Entrance
8 A system for every application	28 Optio 58BD Entrance
10 Tried, tested and trusted	30 GT55 TB Commercial Entrance
14 Window Systems	34 Luminia SC156 Lift & Slide
16 Optio 58BW Casement	36 Optio BSC94 Lift & Slide
18 Optio 58BW ST Heritage	38 Optio BSC94 In-line Sliding
20 Optio 58BW Tilt Before Turn	40 Luminia F82 Bi-fold
24 Door Systems	42 Optio BSF70 Bi-fold
26 Luminia 58BD Flush Entrance	44 Luminia Veranda
28 Optio 58BD Entrance	46 Hardware
30 GT55 TB Commercial Entrance	



5 H 5 @ I ? K 9 6 9 @ = 9 J 9
COLLABORATION IS KING.
= H N G K < M K 9 N F 9 D F C I 8 C :
H < 9 D 5 F H B 9 F G < = D G K 9 N J 9
6 I = @ H K = H < : 5 6 F = 7 5 H C F G 2
INSTALLERS AND
5 F 7 < = H 9 7 H G H < F C I : < C I H
H < 9 I ? 5 B 8 6 9 M C B 8

By experts, for experts

= h Ñ g Z U] f h c g U m k Y j j Y U b X V f Y U h \ Y U i a] b j i a U h 5 i ?
] h g j j h U f c Y j b h \ Y U Y f c g d U W Y j b X i g h f m z h c j h g f Y a U f
_ b c k U V c i h U h c a] W i b i a V Y f % ' " A c f Y j a d c f h U b h m z k Y Ñ f Y Y
a Y h U h c W f Y U h Y \ [\ d Y f Z c f a U b W Y U b X g i g h U j b U V Y k j b X c
g i f d U g g h \ Y b Y Y X g c Z Z U V f] W U h c f g U b X j b g h U Y f g U W f c g g

From the production line to our
ç O Y T E K Q Ç K + O Y M z g O Y D t O G X
member of the AluK team is
K + O K Ç O G T Q 9 k O T G O + ç 4 9 Y 2 k T Y
g M + O g 9 T t O O & U O G 9 T Y O K Q ç M + G
9 G K ç I 9 T M Q K + z K q T + X t K + O Y 9 k K 9 k K Y G O Y T ç O G 9 T K + q M ç O G Q M G 9 G K ç I 9 T M Q
O Q K + O ç Y 9 M ç O Y T E Q D Q E T Q O O G X M + g K Q + O g M Q ç O Q 9 M + G O & U O G 9 Y
and manufacture industry-
leading façade systems for
M t O G X O K G Y
Boasting slimmer sightlines and
E G O K 9 O G z O K 9 + G O M U 9 T M Q Y K + M + G
products are manufactured
9 M 2 k O K T E K O Y 9 U Y 9 K Q ç K G ç Y
So whether commercial or
ç O + O ç Y 9 M ç O Y T E Q D Q E T Q O O G X M + g K Q + O g M Q ç O Q 9 M + G O & U O G 9 Y
Russell
Russell Yates
AluK Managing Director
ç O + O ç Y 9 M ç O Y T E Q D Q E T Q O O G X M + g K Q + O g M Q ç O Q 9 M + G O & U O G 9 Y
K Q ç M T E Q K 9 + G O M 9 X + O

Why choose AluK aluminium systems?

AluK is the leading manufacturer of aluminium window and door design.

But why aluminium?

AluK is the leading manufacturer of aluminium window and door design.

AluK is the leading manufacturer of aluminium window and door design.

AluK is the leading manufacturer of aluminium window and door design.

AluK is the leading manufacturer of aluminium window and door design.

Design

Without compromising on performance, AluK's window and door systems are designed to offer your customers the best of both worlds. Our integrated systems are fast to fabricate and offer a wide range of options to suit your needs.

Our integrated systems are fast to fabricate and offer a wide range of options to suit your needs. We also offer a range of standard single and dual colour products from stock with our Colour+ offer.

Colour

Access a large spectrum of contemporary and classic colour options. We also offer a range of standard single and dual colour products from stock with our Colour+ offer.

We also offer a range of standard single and dual colour products from stock with our Colour+ offer.

For full Colour+ details email info@aluk.co.uk

Security

We understand the importance of security to your business. AluK's window and door systems are independently tested to ensure they not only meet the highest security standards but also offer a wide range of options to suit your needs.

AluK's window and door systems are independently tested to ensure they not only meet the highest security standards but also offer a wide range of options to suit your needs.

Performance

Our window and door systems are designed to offer your customers the best of both worlds. Our integrated systems are fast to fabricate and offer a wide range of options to suit your needs.

Our integrated systems are fast to fabricate and offer a wide range of options to suit your needs. We also offer a range of standard single and dual colour products from stock with our Colour+ offer.

Performance

Each system includes water and draught protection, ensuring they can tackle the most demanding weather conditions. Our integrated systems are fast to fabricate and offer a wide range of options to suit your needs.

Our integrated systems are fast to fabricate and offer a wide range of options to suit your needs. We also offer a range of standard single and dual colour products from stock with our Colour+ offer.

Window Energy Ratings (WERs)

Our aluminium window systems are designed to offer your customers the best of both worlds. Our integrated systems are fast to fabricate and offer a wide range of options to suit your needs. We also offer a range of standard single and dual colour products from stock with our Colour+ offer.

Service excellence

AluK's window and door systems are designed to offer your customers the best of both worlds. Our integrated systems are fast to fabricate and offer a wide range of options to suit your needs. We also offer a range of standard single and dual colour products from stock with our Colour+ offer.

AluK Academy

AluK's window and door systems are designed to offer your customers the best of both worlds. Our integrated systems are fast to fabricate and offer a wide range of options to suit your needs. We also offer a range of standard single and dual colour products from stock with our Colour+ offer.

An AluK system for every application

If there's one thing homeowners, architects, installers and
That's why we've created our wide range of aluminium
façade systems, which meets the needs of different
applications, performance and aesthetic demands.

- From a fabricator and installer
to large-scale refurbishment
offer the superior performance
and quality of aluminium through
- For those looking for the thinnest
sliding door.
- If outstanding quality and
standout at a competitive price
is desired, the Luminia range is
- While stylish design and
everyday practicality is provided

Residential



Multi-Residential



Light commercial



Commercial

Tried, tested and trusted

From trusted favourites to the latest innovations, our comprehensive range of aluminium window and door systems is available in a wide range of finishes and colours to suit your needs at every stage.

performance windows and enhanced security windows

and exceptional build quality

to the latest standards and

you require for successful

Secured By Design and Qualicoat

to the latest standards and

you require for successful

5 @ K 5 M G : I D : H C : H < 9 : H 9 G H





AluK window systems

aluminium window systems that exceed the performance

Manufactured to the highest
standards, AluK window systems
are rigorously tested and meet the most
stringent requirements. They also meet the Secured by
Design standard issued by the
UK Association of Chief Police
Officers.

We understand reputations are
everything. That's why all our aluminium
window systems are rigorously
tested and meet the most
stringent requirements. They also meet the Secured by
Design standard issued by the
UK Association of Chief Police
Officers.

U b X · Z ` Y I] V] `] h m

QKQ5□

kGMSPL9SIPTRTNTLTG;GBL9THMGGRt9gBIH;B9L9g□
I:KLI9YHRI4;B9L9KI;B9IMKYL5B2M9gKI;□
2M9g;IKKI42M9gT95KLGK;BHIRBKM9R9KixRB9O2□
OTYB4B9K(B5GLg2KT954MGKLGlg2K□

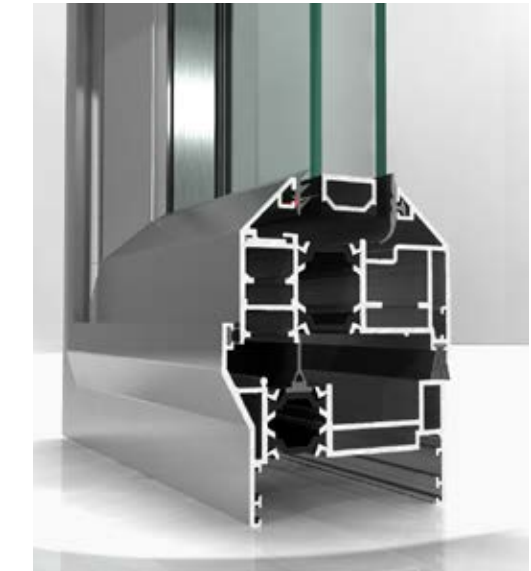

58BW Casement

caseament windows are the perfect choice for both



thermal performance

locking hardware



➤ Square

DTçOI•QEçK&=OTEk9EKYOç•UMQDOg•G1
eM99Mat•QErK&=OTEk9EKYOç•UMQ82M5

QEDSDIMÇOK•QEZGI99TM

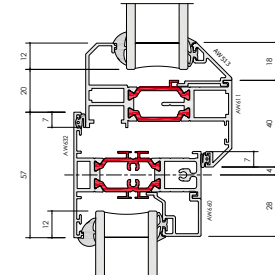
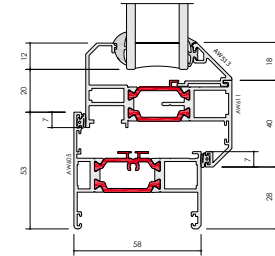
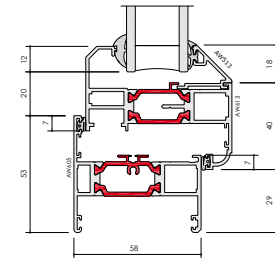
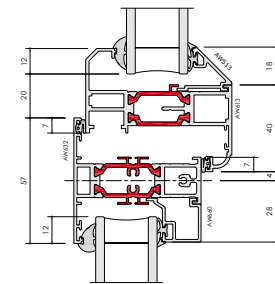

58BW ST Heritage

aluminium windows are an ideal replacement for

4QKççT9TMQMzTqUGOYyT†|OKTEk2kOGqK+KQçKçM•Y9Tg†
UOGzMGqKQgO2kOçOYTEQK+YMGOU†Tgk9OY2kOqTQTk†
YTEk9†TQOYkYMGtK9Oç†T9kY9OO+†TQçM=Yk†+Y9UGM†TçTQE†
Y•UOGTMG†UOGzMGqKQgOKQçYçOg•GT9X†

- Tested to PAS 24
- Green guide rated A
- 4Q9OEKG9OççOOUKOKçUGMEBOYZMGOKYOMzFGTgC+O□
†OQ9T+K9TMQ
- UQT•OUM+XKqTçO9KOGqK+EGOKCçOYTEQ9MTqUGM†O□
thermal performance
- Slim sightlines to match existing steel window
- 4Q9OGQK++XKçOCçZMGOKYOMzFHK=TEQEMQKTEKGTYOUGMRC

- > [qQmCgqrGKqOçOU9k9MKGgmMcK9O□
†KGTGEFZUOYmZKUu+Tg9TMQY]
- > [4Q9OGQK++XMGO&9OGQK++XE#E=Oç
- > [S+K=T[Egqppj
- > [y†KtK+=OmGnZo9TqOlMqOYll□
- > [y†KtK+=OIQKKGQEOmZTGE+OMçPKfM+M•G
KQçKQMçTYOçQTyKOY]
- > [y†KtK+=OIQçKzW++M-TGBYOYKO9TGd9OUUOçEO□
Square and Putty Line
- > [y†KtK+=OIQçKzW++M-TCEGMQE+GK9TMQY9Muk+QE□
YTçOK+QEEM99Mqç•QE8Oç†EK9ç++9TE†EK9KQç□
French casement
- > Double headed option allows for internal glazing
-T9km•99KO•YOMZç=qQX†OQ9Y]
- > Accommodates standard hardware



➤ Square



➤ Putty Line



➤ Stepped Edge

Performance and accreditation

DNTGMB5M:G8gGT@L9g□	7451
DNTGMBKRL:G8gGT@L9g□	7451
yL95IPB9BRg)RTKL9gyEd□	A - B
Green guide rating	A rated
ygM•Y9TgUOGzMGqKQgOqe□	2=xx9Gpe
yTg9TEk9QOYYSk□	x+KYrYk□
VK9OG9TEk9QOYYSk□	x+KYrYrYk□
VTQç=MKçSk□	x+KYrYk□
Security	PAS 24
GçUKG9XgOG9Tgk9IMQ	Q-mark
Secured by design	Yes

Opening	Open out
---------	----------

Top hung	✓
Side hung	✓
Bottom hung	✓
Fixed light	✓
Multi-light	✓
French casement	✓

&l-2M9g4T(PBLg2K□

wl5B2M9g4T(PBlg2K□	24 Kg
eM99Mqk•QEgK&eOTE9□	10KTQE0Y□
IT&Og#TEk9qK&eOTE9□	10

Frame depth	qkQcq
Dual colour option	✓
Multi-point locking	✓
Glazing options	4Q9OGQK+KQcD&9OGQK+
Glazing thickness	qqaq
DTEk9=TIQbGKqO9MaOQ9□	66mm
DTEk9=TIQbOQ92MD•+++IMQ□	qq
DTEk9=TIQbOcnfEk9□	qq

Putty Line	✓
Stepped Edge	✓
Square	✓

LSB2M8MJD,KG8pGTBL9pGL5P1PT8OTGOMGK85M1Y9pEnwA8TKRM(編)
 D5W82M7pGB(KKJBSGL2gPLK2DgJmSLY1gLGK8RHRT48Y15p89BK
 LSB2M8RLR,KG8pGTBL9pGL5P1PT8OTGOMGK85M1Y9pEnwA8TKRM(編wLSB
 2M9pGB(KKJBSGL2gPLK2DgJmSLY1gLGK8RHRT48Y15p89BK
 K8M1Y9pLS6GTpGTGOMGK85M1Y9g2gRB89pLS5BBLK9p7H1R5I4BYLK0LP51pF5BR
 10M1Y9pLS6GTpGTGOMGK85M1Y9g2gRB89pLS5BBLK9p7H1R5I4BYLK0LP51pF5BR
 KOIMYK8M8RHRT49B55,B5GK85M1Y9pLGK8RHRT48Y15p89BK,KOIMKOIMYK9K
 Laminated Glass
 LMU1Y9EQK8eK1ET8K9YQcJUMQqGtMDpFKQ8M2RHM2pQEGTg7M2Y9PKX
 dE10Y9EQK8eK1ET8K9YQcJUMQqGtMDpFKQ8M2RHM2pQEGTg7M2Y9PKX
 eM99Mq1Y9EQK8eK1ET8K9YQcJUMQqD2VdKdGEQY

Technical drawing of a double door assembly. The drawing shows a cross-section of two doors with various dimensions and labels. The dimensions are: 23, 52, 12, 5.5, 28, 6, 4.5, 42.5, 10. The labels are: ANV013, ANV012, ANV010, ANV011, ANV014, ANV015, ANV016, ANV017, ANV018, ANV019, ANV020, ANV021, ANV022, ANV023, ANV024, ANV025, ANV026, ANV027, ANV028, ANV029, ANV030, ANV031, ANV032, ANV033, ANV034, ANV035, ANV036, ANV037, ANV038, ANV039, ANV040, ANV041, ANV042, ANV043, ANV044, ANV045, ANV046, ANV047, ANV048, ANV049, ANV050, ANV051, ANV052, ANV053, ANV054, ANV055, ANV056, ANV057, ANV058, ANV059, ANV060, ANV061, ANV062, ANV063, ANV064, ANV065, ANV066, ANV067, ANV068, ANV069, ANV070, ANV071, ANV072, ANV073, ANV074, ANV075, ANV076, ANV077, ANV078, ANV079, ANV080, ANV081, ANV082, ANV083, ANV084, ANV085, ANV086, ANV087, ANV088, ANV089, ANV090, ANV091, ANV092, ANV093, ANV094, ANV095, ANV096, ANV097, ANV098, ANV099, ANV100.

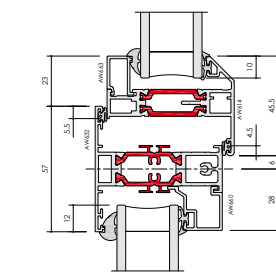
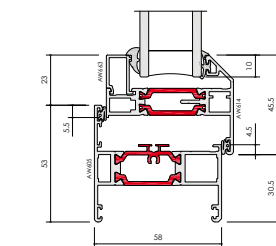
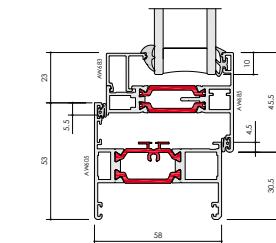

58BW Tilt Before Turn

Made from high performance aluminium these sustainable systems are inherently strong and

Made from high performance aluminium these sustainable systems are inherently strong and



Performance and accreditation

DNTGMB5IM,G8gGT@L9g□	9451
DNTGMBKRL:G8gGT@L9g□	9451
yL95IPB9BRg)RTKL9gyEd□	B - C
Green guide rating	A rated
ygM•Y9TgUOGzMGqKQgOpe□	2=xx9Gpe
yTG9TEK9QOYYK□	x#KYYSK□
VK9OG9TEK9QOYYK□	x#KYYSK□
YTQc#MKcK□	x#KYYSK□
Security	PAS 24
GcUkG9XgOG9TgK9TMQ	Q-mark
Secured by design	Yes

Opening

Tilt before turn	✓
Side hung	✓
Fixed light	✓
Multi-light	✓

&LGK[BHIRBKMR94T(PBLq2M

wL5B2M9g4T(PBLg2K□	5g
xL(B5GLg2K4T(PBLg2K□	5g

Frame depth

Dual colour option	✓
Multi-point locking	✓
Glazing options	4Q9QGK+KQÇO&9OGQK+
Glazing thickness	4444
DTEk9+TQOTGKQ9ZMAOQ9□	44
DTEk9+TQODQG9MD•++TMQ□	44
DTEk9+TQOTf&OçnfEk9□	44

Bay

Contemporary	✓
Square	✓

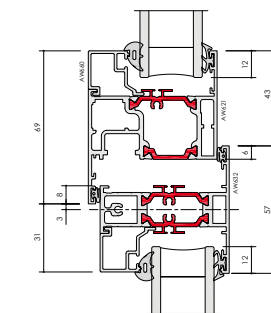
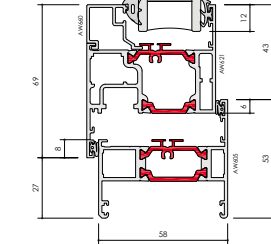

89G = ; B : 95H I F 9G

- ▶ Tested to PAS 24
- ▶ Green guide rated A
- ▶ U_fQ_EGK9C0çç0OUkDKçUGM#EOYZMGOKYOMz9GTgC+O□
†OQ9T+K9TMQ
- ▶ U_fQTP+OUM+XKqTçO9kOGqk+EGOKCçOYTEQ9MTqUGM†O□
thermal performance
- ▶ Sightlines match the casement window

- $LS+K=TE$
 ➤ $TKTK+OTQKQEQOMZTQE+OMC\cdot K+gM+M\cdot G$
 $KQcKQM\zeta YOCQTYkOY$
 ➤ $TKTK+OTQKQOM+M-TQEQYK9Tg$
 $eKXMQ9OqUMGKGXKQcDP\cdot KGO$
 ➤ $TKTK+OTQKQOM+M-TQEQMCF\cdot GK9TMQY$
 $9T+9\cdot OzMG09\cdot GYTCOK\cdot QE8OC\cdot TEK9KQcQ\cdot +9TEK9$
 ➤ $TKTK+OzMGfz9TqOIMQY$

[illegible]

58BW
Top Swing
F Y j Y f

=XYU`"Zcf`igY`j b`\\[\\!f]gY`ghfiWhifYgž`h\\Y`k]bXckg`cdYb`
Ub`]adFyGg]jY`%, \$šž`U`ck]b[`Wcad`YhY`m`dU]b]ZfY`
dUbY`W`YUb]b["`H\\Y`gmghYa`XcYg`bch`YbWf`cUW`]bg]XY
h\\Y`Vi]`X]b[ž`Ug`h\\Y`aYW\\Ub]ga`b`ckg`h\\Y`cdYb]b[
ash to completely rotate on itself remaining
M•9YTcO9kO•tT+cTQEY9G•g9•GO



- Tested to PAS 24
- Green guide rated A
- 4Q9OEKG9OççpOOUkOKçUGM#OYZMGOKYOMz9GTgC+O□
‡OQ9T#K9TMQ
- LuQTP+OUM+XKqCçpKOGqk+EGOKCçOYTEQ9MTqUGM‡O□
thermal performance
- çy#OKQKPKUUKGKGQçO9MFT#OK9G+O□
contemporary aesthetic
- pOYTEQK#M=Y9KO#TQçM=Y9M#OUI#M9OççT9km+9□
intruding the internal building line

➤ $\mathbb{C} \times K = \mathbb{Q} \oplus \mathbb{E} \oplus \mathbb{Q} \oplus \mathbb{Q}$
 ➤ $\mathbb{Y} \mathbb{I} \mathbb{K} \mathbb{H} = \mathbb{O} \mathbb{I} \mathbb{Q} \mathbb{K} \mathbb{Q} \mathbb{E} \mathbb{O} \mathbb{M} \mathbb{Z} \mathbb{Q} \mathbb{E} \mathbb{O} \mathbb{M} \mathbb{G} \mathbb{P} \mathbb{K} \mathbb{G} \mathbb{M} \mathbb{M} \mathbb{G}$
 $\mathbb{K} \mathbb{Q} \mathbb{C} \mathbb{K} \mathbb{Q} \mathbb{M} \mathbb{C} \mathbb{T} \mathbb{Y} \mathbb{O} \mathbb{C} \mathbb{Q} \mathbb{T} \mathbb{Y} \mathbb{O} \mathbb{Y}$
 ➤ $\mathbb{Y} \mathbb{I} \mathbb{K} \mathbb{H} = \mathbb{O} \mathbb{I} \mathbb{Q} \mathbb{K} \mathbb{O} \mathbb{M} \mathbb{H} \mathbb{M} = \mathbb{T} \mathbb{Q} \mathbb{E} \mathbb{O} \mathbb{Y} \mathbb{K} \mathbb{O} \mathbb{T} \mathbb{Q} \mathbb{E} \mathbb{K} \mathbb{O}$
 Contemporary and Chamfered
 ➤ $\mathbb{Y} \mathbb{I} \mathbb{K} \mathbb{H} = \mathbb{O} \mathbb{I} \mathbb{Q} \mathbb{K} \mathbb{O} \mathbb{M} \mathbb{H} \mathbb{M} = \mathbb{T} \mathbb{Q} \mathbb{E} \mathbb{M} \mathbb{G} \mathbb{E} \mathbb{P} \mathbb{K} \mathbb{Y} \mathbb{M} \mathbb{Q} \mathbb{Y}$
 $\mathbb{Y} \mathbb{M} \mathbb{U} \mathbb{Y} = \mathbb{T} \mathbb{Q} \mathbb{T} \mathbb{C} \mathbb{O} \mathbb{Y} \mathbb{H} = \mathbb{T} \mathbb{Q} \mathbb{E} \mathbb{O} \mathbb{C} \mathbb{P} \mathbb{E} \mathbb{K} \mathbb{Y} \mathbb{K} \mathbb{Q} \mathbb{C} \mathbb{Q} \mathbb{P} \mathbb{H} \mathbb{E} \mathbb{K} \mathbb{Y}$
 ➤ $\mathbb{P} \mathbb{O} \mathbb{C} \mathbb{T} \mathbb{g} \mathbb{Y} \mathbb{O} \mathbb{C} \mathbb{E} \mathbb{T} \mathbb{Q} \mathbb{E} \mathbb{Y} \mathbb{G} \mathbb{T} \mathbb{U} \mathbb{Y} \mathbb{Z} \mathbb{M} \mathbb{G} \mathbb{O} \mathbb{K} \mathbb{Y} \mathbb{O} \mathbb{M} \mathbb{Z} \mathbb{T} \mathbb{Q} \mathbb{Y} \mathbb{K} \mathbb{H} \mathbb{P} \mathbb{K} \mathbb{Y} \mathbb{M} \mathbb{G}$
 ➤ $\mathbb{H} \mathbb{P} \mathbb{H} \mathbb{G} \mathbb{K} \mathbb{Q} \mathbb{E} \mathbb{O} \mathbb{M} \mathbb{Z} \mathbb{g} \mathbb{P} \mathbb{Y} \mathbb{M} \mathbb{q} \mathbb{T} \mathbb{Y} \mathbb{L} = \mathbb{O} \mathbb{K} \mathbb{K} \mathbb{G} \mathbb{C} = \mathbb{K} \mathbb{G} \mathbb{O} \mathbb{K} \mathbb{I} \mathbb{K} \mathbb{H} \mathbb{K} \mathbb{P} \mathbb{O}$

Performance and accreditation	Outward opening
DNTGMB5IM,CBgGT@L9g	PAS
Green guide rating	A rated
yTG9TEK9QOYY5K	x#KYY5K
VK9OG9TEK9QOYY5K	x#KYY5K
YTQC#MCK5K	x#KYY5K
Security	PAS 24
GcUKG9XgOG9TgK9TMQ	Q-mark
Secured by design	Yes

Opening	Open out
Top swing	✓
Side swing	✓
Fixed light	✓
Multi-light	✓

&l:YPl9g4t(PBlg2K□	sg
wL5BYPl9g4t(PBlg2K□	45 Kg
lT&OçitEk9qK&EOTEk9□	iti

Frame depth	44
Dual colour option	✓
Multi-point locking	✓
Glazing options	4Q9OGQK±
Glazing thickness	4444
D+TEk9#TQOTGKqO9MaDQ9□	44
DTEk9#TQODQ9ZMd***TMQ□	161mm

Resinetics	
Bay	✓
Contemporary	✓
Square	✓

The technical drawing is a detailed floor plan of the ground floor ('Pavimento') of the Casa de la Museo. It features several rooms, including a large central hall, a kitchen area, and multiple bedrooms or living spaces. Dimensions are provided in meters: the total width is 70m, and the total depth is 59m. Individual room widths include 18m, 27m, 12m, 56m, and 40m. Wall thicknesses are indicated as 0.15m and 0.20m. Door swings are shown with arcs, and windows are represented by double lines. Red highlights indicate specific structural or design elements.

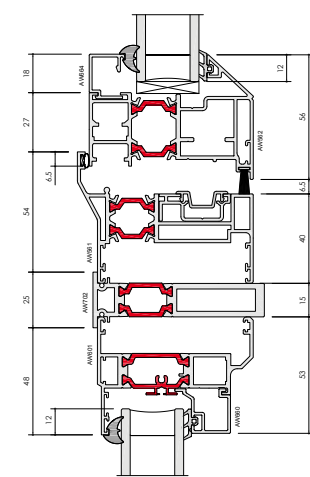

```
I j U i Y n f c i V Y ; Un] b[ e l K] bXckg_ UfY' WU' Wi' UhYX' ig] b['9B'=GC'%$%+; i' DUfh'&%&' Saa'i' %
][\h'k] h\i' i' '%$S'K#a? 'ig] b['5K)'%'ci hfZfUaY' UbX' 5K)'&' i' Ybh
: fYbY' i' XY' fUH] b[ i' 7U' Wu UhYX' ig] b[\hY'; fYbY' i' XY'&$$, 'fUh] b[g' Zcf' WcaaYfW] U' i' k] bXc
5'ia] b] ia] k] bXck' nDfcU' Y'0*&) _[ #at' XciV' Y' i' UnYX
Hcd' Gk] b[ naU' i' KY] [\h'e' i' 6UGyX' i' dcb' DB' i' b] Hcdgk] b[ : Yuf] b[
G] XY' Gk] b[ naU' i' ky] [\h'e' i' 6UGyX' i' dcb' DB' i' b] G] XYgk] b[ : YUF] b[
```



AluK door systems

Engineered to integrate seamlessly with our window system range, our aluminium door systems remain our most popular products and provide unrivalled safety, security and installation simplicity.

Each door system has its own 4QKççI9IMQ9MqOO9TQE9kOQOOçY.
çTY9TQg9#MMCKQçzOO+MzzOGTQE□MzO†OGXKU+TgK9IMQ9XUOM•G□
†KGTQE#O†O+YMzUOGzMGqKQgO□doors also support the current
UGM#OçOU9kKQçE#K=IQEKGOK□ industry trend for refurbishment
M†OGGOU+KgOqOQ9□
IM=O†OGEK†+OM•GçOYTEQYqKX□
çTzzOGXM•#+QçM•GqK9OGTK+YKQçThis allows fabricators and installers
manufacturing processes are as 9MUGM†TçO9kOKççI9IMQK+#TEk9KQç□
GO+TK=+OKYO†OGHM•KK†OM•G□ YUKgO9kOIGg•Y9MqOGY#KQ9TQ9kO□
E•KGKQ9OOY#OKGMQOTQzKg9□ qMY999TQE#KXUMYY†+O□

58BD Flush Entrance

g m g h Y a " 5 j U] \ U V \ Y \] b \ j U f] Y h m \
g \] a \ g] [\ h \ \ b Y g \ U b X \ Ü i g \ \ U Y g h \



YIKT+K+OTQYTQE+OKQçç•K+gM+M•G

ÇM=++0EK=IQE9YKKGQqQcEOD=YYUKgOGGIXGQ
y++0K9KG0G0Y9YçK9K9KCOQZGMqBdKGF9YdD8YQç
*UMQ0K0EIKQY0D0ZMGçTQEGmGMGMQçGK9TMYQ
DM=ÇQIQY=+9TMYQK=+OYKG0Z-GQç=g9TMYQK=+OYKQçEG0IXYQç
MQ0Y9Y9TQEGK=+Y9TgH=IQEED
S=OKYOçTMYQK=ÇgmçÇ2MçÇ-Q+MKGK=+B4dgMqUMQOG9YKçKçpY0E

Technical drawing of a window frame cross-section. The drawing shows a vertical section of a window frame with various components and dimensions. Key dimensions include a total height of 12, a top section height of 12, a middle section height of 12, and a bottom section height of 12. The width of the frame is 75. Components labeled include: A-12-124, A-12-143, A-12-122, A-12-123, A-12-124, A-12-125, A-12-126, A-12-127, A-12-128, A-12-129, A-12-130, A-12-131, A-12-132, A-12-133, A-12-134, A-12-135, A-12-136, A-12-137, A-12-138, A-12-139, A-12-140, A-12-141, A-12-142, A-12-143, A-12-144, A-12-145, A-12-146, A-12-147, A-12-148, A-12-149, A-12-150, A-12-151, A-12-152, A-12-153, A-12-154, A-12-155, A-12-156, A-12-157, A-12-158, A-12-159, A-12-160, A-12-161, A-12-162, A-12-163, A-12-164, A-12-165, A-12-166, A-12-167, A-12-168, A-12-169, A-12-170, A-12-171, A-12-172, A-12-173, A-12-174, A-12-175, A-12-176, A-12-177, A-12-178, A-12-179, A-12-180, A-12-181, A-12-182, A-12-183, A-12-184, A-12-185, A-12-186, A-12-187, A-12-188, A-12-189, A-12-190, A-12-191, A-12-192, A-12-193, A-12-194, A-12-195, A-12-196, A-12-197, A-12-198, A-12-199, A-12-200, A-12-201, A-12-202, A-12-203, A-12-204, A-12-205, A-12-206, A-12-207, A-12-208, A-12-209, A-12-210, A-12-211, A-12-212, A-12-213, A-12-214, A-12-215, A-12-216, A-12-217, A-12-218, A-12-219, A-12-220, A-12-221, A-12-222, A-12-223, A-12-224, A-12-225, A-12-226, A-12-227, A-12-228, A-12-229, A-12-230, A-12-231, A-12-232, A-12-233, A-12-234, A-12-235, A-12-236, A-12-237, A-12-238, A-12-239, A-12-240, A-12-241, A-12-242, A-12-243, A-12-244, A-12-245, A-12-246, A-12-247, A-12-248, A-12-249, A-12-250, A-12-251, A-12-252, A-12-253, A-12-254, A-12-255, A-12-256, A-12-257, A-12-258, A-12-259, A-12-260, A-12-261, A-12-262, A-12-263, A-12-264, A-12-265, A-12-266, A-12-267, A-12-268, A-12-269, A-12-270, A-12-271, A-12-272, A-12-273, A-12-274, A-12-275, A-12-276, A-12-277, A-12-278, A-12-279, A-12-280, A-12-281, A-12-282, A-12-283, A-12-284, A-12-285, A-12-286, A-12-287, A-12-288, A-12-289, A-12-290, A-12-291, A-12-292, A-12-293, A-12-294, A-12-295, A-12-296, A-12-297, A-12-298, A-12-299, A-12-300, A-12-301, A-12-302, A-12-303, A-12-304, A-12-305, A-12-306, A-12-307, A-12-308, A-12-309, A-12-310, A-12-311, A-12-312, A-12-313, A-12-314, A-12-315, A-12-316, A-12-317, A-12-318, A-12-319, A-12-320, A-12-321, A-12-322, A-12-323, A-12-324, A-12-325, A-12-326, A-12-327, A-12-328, A-12-329, A-12-330, A-12-331, A-12-332, A-12-333, A-12-334, A-12-335, A-12-336, A-12-337, A-12-338, A-12-339, A-12-340, A-12-341, A-12-342, A-12-343, A-12-344, A-12-345, A-12-346, A-12-347, A-12-348, A-12-349, A-12-350, A-12-351, A-12-352, A-12-353, A-12-354, A-12-355, A-12-356, A-12-357, A-12-358, A-12-359, A-12-360, A-12-361, A-12-362, A-12-363, A-12-364, A-12-365, A-12-366, A-12-367, A-12-368, A-12-369, A-12-370, A-12-371, A-12-372, A-12-373, A-12-374, A-12-375, A-12-376, A-12-377, A-12-378, A-12-379, A-12-380, A-12-381, A-12-382, A-12-383, A-12-384, A-12-385, A-12-386, A-12-387, A-12-388, A-12-389, A-12-390, A-12-391, A-12-392, A-12-393, A-12-394, A-12-395, A-12-396, A-12-397, A-12-398, A-12-399, A-12-400, A-12-401, A-12-402, A-12-403, A-12-404, A-12-405, A-12-406, A-12-407, A-12-408, A-12-409, A-12-410, A-12-411, A-12-412, A-12-413, A-12-414, A-12-415, A-12-416, A-12-417, A-12-418, A-12-419, A-12-420, A-12-421, A-12-422, A-12-423, A-12-424, A-12-425, A-12-426, A-12-427, A-12-428, A-12-429, A-12-430, A-12-431, A-12-432, A-12-433, A-12-434, A-12-435, A-12-436, A-12-437, A-12-438, A-12-439, A-12-440, A-12-441, A-12-442, A-12-443, A-12-444, A-12-445, A-12-446, A-12-447, A-12-448, A-12-449, A-12-450, A-12-451, A-12-452, A-12-453, A-12-454, A-12-455, A-12-456, A-12-457, A-12-458, A-12-459, A-12-460, A-12-461, A-12-462, A-12-463, A-12-464, A-12-465, A-12-466, A-12-467, A-12-468, A-12-469, A-12-470, A-12-471, A-12-472, A-12-473, A-12-474, A-12-475, A-12-476, A-12-477, A-12-478, A-12-479, A-12-480, A-12-481, A-12-482, A-12-483, A-12-484, A-12-485, A-12-486, A-12-487, A-12-488, A-12-489, A-12-490, A-12-491, A-12-492, A-12-493, A-12-494, A-12-495, A-12-496, A-12-497, A-12-498, A-12-499, A-12-500, A-12-501, A-12-502, A-12-503, A-12-504, A-12-505, A-12-506, A-12-507, A-12-508, A-12-509, A-12-510, A-12-511, A-12-512, A-12-513, A-12-514, A-12-515, A-12-516, A-12-517, A-12-518, A-12-519, A-12-520, A-12-521, A-12-522, A-12-523, A-12-524, A-12-525, A-12-526, A-12-527, A-12-528, A-12-529, A-12-530, A-12-531, A-12-532, A-12-533, A-12-534, A-12-535, A-12-536, A-12-537, A-12-538, A-12-539, A-12-540, A-12-541, A-12-542, A-12-543, A-12-544, A-12-545, A-12-546, A-12-547, A-12-548, A-12-549, A-12-550, A-12-551, A-12-552, A-12-553, A-12-554, A-12-555, A-12-556, A-12-557, A-12-558, A-12-559, A-12-560, A-12-561, A-12-562, A-12-563, A-

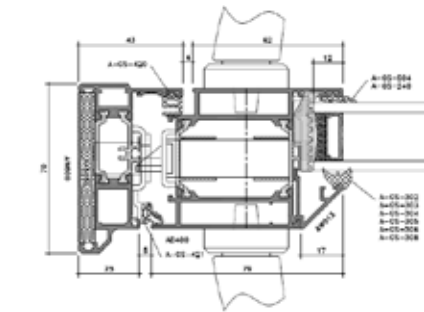
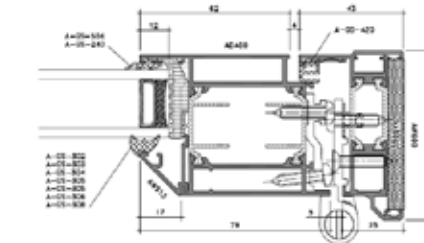

Door slides and stacks
9M9KOE0Z9

Door slides and stacks
9M9kOGTEK9L

Door opens
9M9kOEOz9D

Door opens
9M9kOGTEk9

Fixed UKQO±



58BD Entrance

oBYLq9B5PLK2YBOMRLK)T95B(L,LGLK)HRI9KI4L95□
O†OGXqmmGTQ9kOGKQEOTYK†K†K+†OTQY†QE+O
KQqpm•†+OgMQE•GK9TMQYqKCTQE9kOq
TcOK+zMGK†qMY9KQXKU+TgK9TMQ□







➤ cBRKLB5M95BRK2BwBOMRB5JpBYLg9YO2B4B

- Tested to PAS 24
 - Multi-point locking mechanism
 - Designed to incorporate standard and security hardware using the same prep detail
 - $X \neq MKCTQEPZOK9 \cdot GOGMqGOK + Y \neq MgCKQ\zeta UGO \uparrow OQ$
any access to locking points
-
- OPTIONS**
- $\zeta s + K = TQEnppj$
 - $QqMGGpZGKqO\phi OU9K9MKggMqgm\zeta K9O \square$
 $\uparrow KXGTQEPZUOYmZkUU + TgK9TMQY$
 - Low threshold option for Part M – Building regulation
 - $TyKtK + \phi OTQKQEQFMZTQE + OM\zeta G \cdot K + gM + M \cdot GKQ \square$
 $KQM\zeta TYO\zeta QTYKOY$
 - $TyKtK + \phi OMGGO - \square \uparrow OMGGO \cdot G - TyKQOQ9JGMRG9Y$
 - $TyKtK + \phi OTQTE + OM\zeta Gm \cdot \#OgMMGmG\zeta E + CK9TMQ$





Performance & accreditations	Single open in	Single open out
Air permeability	x#KYY6K□	x#KYY6K□
Water penetration	x#KYY6K□	x#KYY6K□
Wind resistance	x#KYY6K□	x#KYY6K□
Building regulations part L compliant	✓	✓
Building regulations part M compliant	✓	✓
Building regulations part Q compliant	✓	✓
U _T K=•OqM••+OE#K=IQE□	Wq□	Wq□
U _T K=•OqGTU+OE#K=IQE□	Wq□	Wq□
ITGOm□	npd	npd
DqMCOm□	npd	npd
Security	PAS 24	PAS 24
GçUKG9XgOG9TgK9TMQ	Q-mark	Q-mark
Secured by design	Yes	Yes
p•GK-I#T9XrogK9OEMGX	EXg+OY	EXg+OY
System depth		
D9LKY44□	44T9544	44T9544
Design features		
Thermally broken	✓	✓
Low threshold	✓	✓
Panel door	✓	✓
Feature design - rounded contours	✓	✓
DTEk9+TQOtOKç□	qç	qç
DTEk9+TQOçT+•□	111mm	111mm
DTEk9+TQOWKq+□	qç	qç
DTEk9+TQODOO9TQED9T+O□	qç	qç
Hardware		
Multi-point locking	✓	✓
Barrel hinges	✓	✓
Finishes		
Single colour	✓	✓
Dual colour	✓	✓
Textured	✓	✓
Maximum sizes and weights		
Maximum door leaf size	qç&qç	qç&qç
Maximum door leaf weight	15	15
Maximum glazing thickness	qçqç□	qçqç□

8ci V'Y'cdYb j8ci V'Y'cdYb'ci h	
x=KYyK□	x=KYyK□
x=KYyK□	x=KYyK□
x=KYyK□	x=KYyK□
✓	✓
✓	✓
✓	✓
Mq□	Mq□
Mq□	Mq□
npd	npd
npd	npd
PAS 24	PAS 24
Q-mark	Q-mark
Yes	Yes
Xg+OY	Xg+OY
44T95d4	44T95d4
✓	✓
✓	✓
✓	✓
✓	✓
dq	dq
111mm	111mm
dq	dq
dq	dq
✓	✓
✓	✓
✓	✓
✓	✓
✓	✓
dq&dq	dq&dq
▣	▣
dqqq□	dqqq□

Key

Symbol	Description
	Door slides and stacks 9M9KLOE0z9
	Door slides and stacks 9M9KLOGTEK9
	Door opens 9M9KLOE0z9
	Door opens 9M9KLOGTEK9
	Fixed UKQO+

Single

			
---	---	---	---

Double

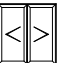
	
---	---



GT55 TB Commercial Entrance

The GT55 TB commercial door system provides the most comprehensive PAS24 security for single, double and screen doors.

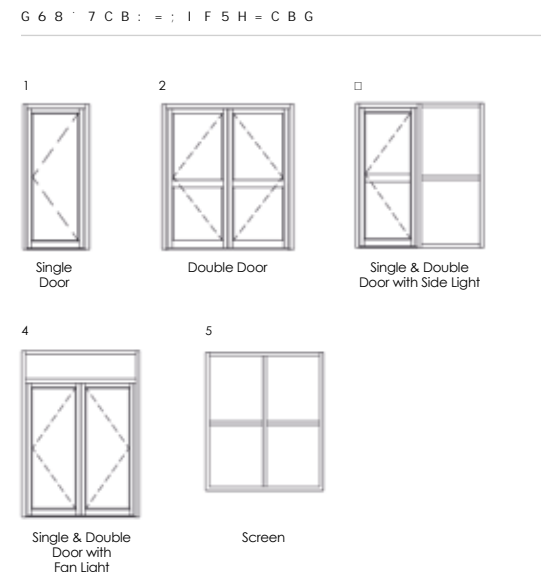

- Options: Mechanical locking, Multi-point locking, Concealed hinges, Barrel hinges, Electro-mechanical locking, Security glazing, etc.

Options	GT55 TB	GT55 TB Screening	GT55 NI	GT55 NI Screening
Double acting	✓	-	✓	-
Single colour	✓	✓	✓	✓
Dual colour	✓	✓	-	-
Textured	✓	✓	✓	✓
Anodised	✓	✓	✓	✓

AluK Part Ref	Relevant	SINGLE DOOR				SCREEN			
		Min (w)	Min (h)	Max (w)	Max (h)	Min (w)	Min (h)	Max (w)	Max (h)
GT55 TB Single Door	□	□	-	□	□	□	-	□	□
GT55 TB Double Door	□	□	-	□	□	□	-	□	□
GT55 TB Screen	□	□	-	□	□	□	-	□	□

SPECIFICATIONS

Performance and accreditation	GT55 TB		GT55 TB Screening	GT55 NI		GT55 NI Screening
	Single	Double		Single	Double	
Performance	Class 1A	Class 1A	Class 4	Class 1A	Class 1A	Class 4
Security	Q-mark	Q-mark	Q-mark	Q-mark	Q-mark	-
Thermally broken	✓	✓	✓	-	-	-
Low threshold	✓	✓	-	✓	✓	-
Sightlines	145 mm	145 mm	55 mm	144 mm	144 mm	55 mm
Feature design - angular contours	✓	✓	✓	✓	✓	✓
Mid-rail and lay bar	✓	✓	✓	✓	✓	✓
Panel door	✓	✓	-	✓	✓	-
Multi point locking	✓	✓	-	-	-	-
Single point locking	✓	✓	-	✓	✓	-
Concealed hinges	✓	✓	-	✓	✓	-
Barrel hinges	-	-	-	✓	✓	-
Electro mechanical locking	✓	✓	-	✓	✓	-
Security glazing	✓	✓	-	✓	✓	-
Maximum door weight	250 kg	250 kg	250 kg	250 kg	250 kg	250 kg
Maximum glazing area	npd	npd	6 - 12	6 - 12	6 - 12	6 - 12
Applications	Refurbishment	Refurbishment	Refurbishment	Refurbishment	Refurbishment	Refurbishment

Technical specifications and details for the GT55 TB Commercial Entrance system, including performance, security, and application information.



= B : = B = I A Sliding

= bÜb] i a`Vf] b[g`hc[Yh\Yf`] bXccf`U
living spaces in exquisite harmony.

xRBBiPL9gY-TOBYTRBORBTKB5K2T93YKIYKM99L9gG]□
YGL4Y1g2KGL9BYK2TK,TK2BBNBRJYMRHTOBPLK29TKMRTGGlg2K□
D9L9KBRRM-KB5-T9IRT4LOCT95YOT-BY-RINL5BOI4-GBK8□
BYOT-LY4PLK2IMK9BB5IHBYOT-B□

y2LGBYBT4GBYYG)L9KBgRTKB5IRKIOBLGL9ggGT@L9g□
RBEOKYK2BOGTRLKJHK2IMg2K,B2L95BNBRJL9Y-LRB5□
5BYLg95BOLYU9□

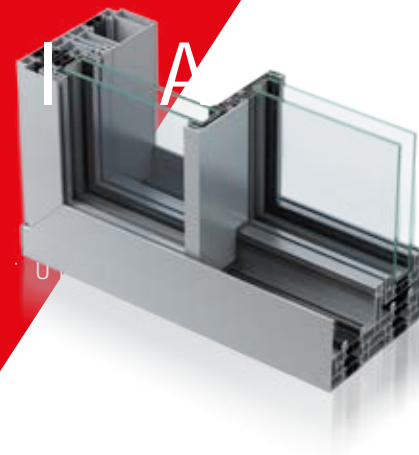

8 9 G = : B : : 9 5 H I F 9 G

- Sliding door
- Fully concealed outer-frame
- 21mm central interlock
- One or more opening panels with large width
çT@QQYTMQY+U9MgYKQçKOTEK9□
çT@QQYTMQY+U9MgYKQçKOTEK9□
- □IM+çY+U9MgYKQçKOTEK9□

OPTIONS

- □YKH+OQçM+çOMGçTU+OçKçC
- □sK=TQEMU9TMQYMAçççç
- Floating corner post option for larger opening space
- □DTQE+OçM+M+GKIKTK+çOKMY9KQçKGç
- □YKH+OçKçKQçOMçMçCE+çK9TMQY□
- □pM+çOMGçTU+OçK=TQçYM+ç9TMQYKIKTK+çO on the same outer-frame

SPECIFICATIONS

Performance & accreditations

DPSTGMBoIM,G8pGT@L9g□	y4s□
DPSTGM8&RL-G8pGT@L9g□	y4s□
Air Tightness	x#KYYçK□
Water Tightness	x#KYYççK□
Wind Load	x#KYYççKçU9MçQçK□

Size limits

Max Sash Weight	çE
Max Sash Dimension	çççççç□

System features

Dual colour option	✓
Multi-point locking	✓
Glazing options	ççççç

= B : = B = I A` 7 CB : : I F 5 H = CB G

➤Key

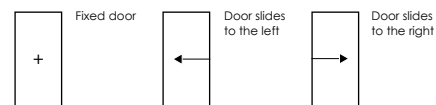

&2B5LTgRT4YY2IPB52BRBLGGMYKRTKBYI4BIHK2BOI9gMRTKLI9Y□
TO2LBNT,G8PLK2çGMsYr99LM4Y)YKB4□

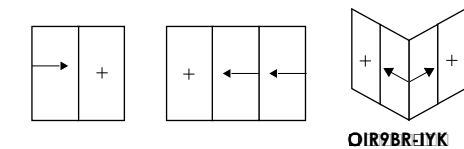
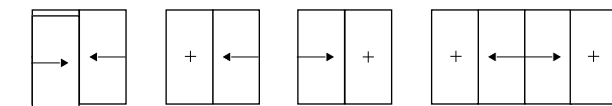

OIR9BR=IYK

CAD CROSS SECTIONS

4Q9OG+MgC

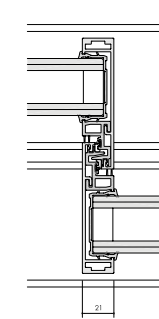

IT4,çBKTLG

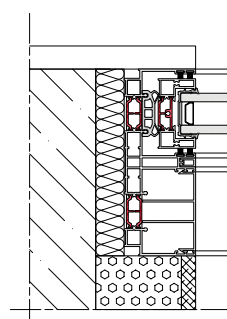

Sill Detail

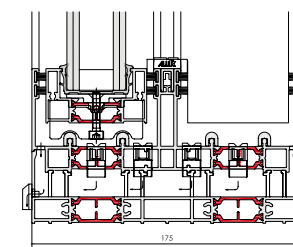

Luminia

SC156 Lift & Slide

A premium sliding door with slim
g] [\ h] b Y g z i U j U] ^ U V ^ Y i] b i U j U f] Y h m e z i g] [X]
W c b U [i f U h] c b g i i g] b [i g] b [^ Y i U b X i X c i V i]
track systems.

&2BwclHhBRY2Lg2GBNBGYIH=BRHIR4T9OBHRI4
K2BR4TGDNTGMBYIH4sKRL=GBgGT@B5KIYM=BRIR
PTKBRKLg2K9BYI9K2B4TR3Bm1T95PLK2=198G
PBLg2KYIHM-Kkg

Smooth operation is guaranteed through the use
Mz9kOKTEkOY9PpK+T9X9PTQEY

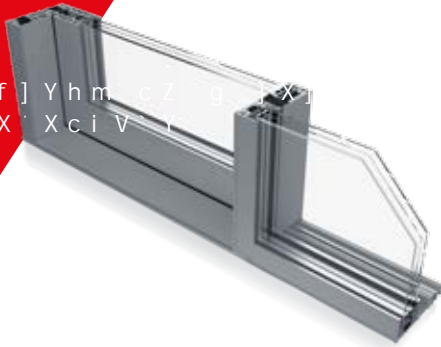

8 9 G = : B : 9 5 H I F 9 G

- » kOOB=KY44445IM,GBIRKRL=GBgGT@L9g
- » IT@G=198GPBLg2K
- » IPK2RBY2IG5IH44
- » Exceptional AWW ratings

OPTIONS

- » G i] a a Y f i g] [\ h] b Y i c z i) \$ a a i U j U] ^ U V ^ Y i]
- » A i i h] d i Y i g i] X] b [i W c b U [i f U h] c b g
- » Mono or Dual rail options
- » yIKH+QIGTGEHOKQpK+gM+M+G
KQXM9kOG2ynK+YMKHKT+K+O
- » Range of hardware and security features

SPECIFICATIONS

Performance and accreditation

DNTGMBoIM,GBpGT@L9gDgyM
UfK+*OLGTU+Os+K=TQEdEMq
UfK+*OpM+*Os+K=TQEdEMq
UfK+*OLGTU+Os+K=TQEdEMq
ygm+Y9TgSOGzMGqKQgOQe
yTGUTEk9QOYYsK
VK9OGUTEk9QOYYsK
VTQcBMKcSK

SC156

Mq
Mq
Mq
Mq
2=x9x9Gqe
x+KYYsK
x+KYYsK
xSK

7cbU[i fUh]cb / / ZfUaY

Opening
dMQMGKT+qq
p+K+GKT+qq

Lift & slide
✓
✓

Size limits

IT(NB9KPBLg2K
IT(HRT4B2BLg2K

8g
d4

System features

Sightlines
Dual Colour Option
Multi-point locking
Glazing options
Glazing thickness
Threshold

95mm
✓
✓
4Q9OGQK+
qqqq
qq

G 7 %) * i f @ = : H i / i G @ = 8 9 E i 7 C B = : i f 5 H = C B G

Key

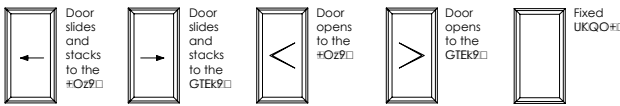

Mono Rail

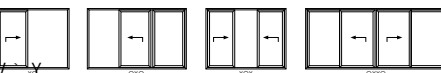

Dual Rail

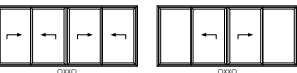
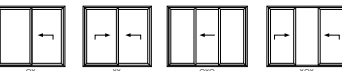

X = Sliding
O = Fixed

CAD CROSS SECTIONS

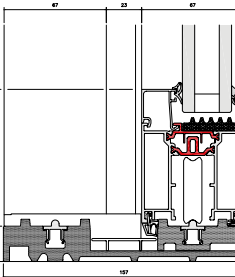
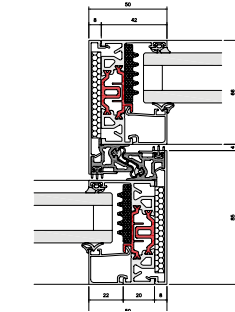
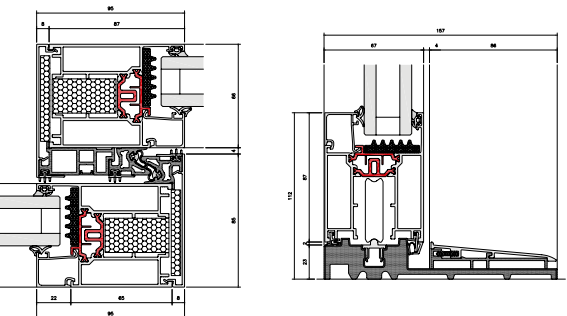

Note: npd = No performance declared, image used for illustration purpose only
mGBTYBNLYLKPPPTGM3OIM3KISIP9GIT5TGGJfOJ4=19B9KYT5cKaGBY

BSC94

Lift & Slide

&2BR4TGDSTGMBYIH74sKRL-GBgGT@B5mT9BG
PBLg2KYIHM-KlgwLg2KGL9BYTYGLKKGBTY44

&2BGLYKgiBYI9kY5IK2BjB9BKYL9OGM5L9g4MGKL=GB
OI9gMRTKLI9YT95TPL5BO2ILOBIHOIGIMR9LY2BY



▶ kOOB-KY4445IM,GBgGT@L9g

▶ iT(3g-T9BGPBLg2K5IM,GB,IgB)



▶ ☐ KNTLGT,GBY9GL9BWGL5L9c

- Range of hardware and security features

Performance and accreditation

DNTGMBSIM,GBgGT@L9gDgpfA	2iqMQMGKT#□	Wq□
u#K#••O@GTU+O#K=IQEdEmq	2iqMQMGKT#□	Wq□
u#K#••OqM#••#O#K=IQEdEmq	2iq#K#GKT#□	Wq□
u#K#••O@GTU+O#K=IQEdEmq	2iq#K#GKT#□	Wq□
Green guide rating		C rated
ygM#Y9TgUOGzMGqGgOpe□		npd
yTG9TEk9QOYY\$K□		x#KYy\$K□
YK9OG9TEk9QOYY\$K□		x#KYy\$K□
YTQ#EMK\$K□		x\$K□
7 c b Ū [i f U h] c b ' / ' ' Z f U a Y		
Opening		Lift & slide
dMQMGKT#q□		✓
p#K#GKT#q□		✓
Size limits		
II(NB9KPBlg2K□		8g
II(HRT4B2Blg2K□		44
System features		
Dual colour option		✓
Multi-point locking		✓
Glazing options		4Q9OGGK#
Glazing thickness		q□q□
Sightlines		q□

Key

	Door slides and stacks to the #O29□		Door slides and stacks to the GTEK9□		Door opens to the #O29□		Door opens to the GTEK9□		Fixed UKG0□
---	-------------------------------------	---	--------------------------------------	---	-------------------------	---	--------------------------	---	-------------

Mono Rail

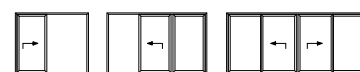

Dual Rail



BSC94

Mq
Mq
Mq
Mq
C rated
npd
x#KYY6K
#KYY6K
x6K

BSC94SLIM

x

x

mq□

mq□

C rated

npd

x#KYyBK□

x#KYyBK□

yBK□

Lift & slide

x

✓

Bg

d4

✓

✓

4Q9OGQK#

qqqq

45mm

Technical drawings of the door assembly, including cross-sections and details of the door frame and hardware.

Mono Rail – Cill

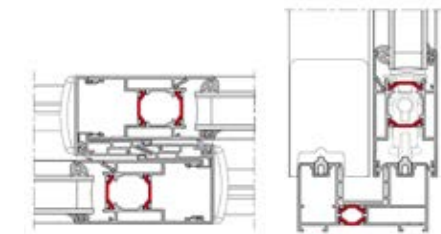

Dual Rail – Cill

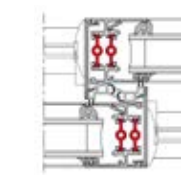

8 i U` ` F U] ` # H f] ` F U] ` ` |
D9KQçKGçD+Tq+TQO4Q9OG+MgC

Note: npd = No performance declared

BSC94

In-line Sliding

IT9MHTOKMRB5K1K2B2Lg2BYKD5YKT95TR5Y
9kTYq=+9TGMQE+GK9TMQIT+IQOYXY9OqMzZOGY
outstanding thermal performance and
K+TcOGKQEOMzj+Y9MqTYK+OMU9TMQY





- Anti bi-metal polyamide strip to allow
- zMGfKCGXTQEO&UKQYTMQGGK9OY

▶ $\gamma \text{IKTK} + \text{OQmZDFCO}$
 ▶ $\text{D} + \text{TqQOGYTEK9} + \text{TQOMapqIKTK} + \text{FO}$
 ▶ $\text{d} + \text{9TU} + \text{OY} + \text{TcTQEgMQE} + \text{GK9TMQY}$
 ▶ $\text{dMQMp} + \text{K} + \text{MGLTGKT} + \text{MU9TMQY}$
 ▶ $\gamma \text{IKTK} + \text{OQTCFCKQc} + \text{KgmHM} + \text{G}$
 □ $\gamma \text{QMCTyOCQTYKDYKHYMKTK} + \text{FO}$

SPECIFICATIONS

Performance and accreditation		BSC94
DNTGMBSIM,G8gGT@L9gDgpf	2iqMQMGKT#□	8dq□
u†K#•O2GTU+OE#K=†QEaE8q	2iqMQMGKT#□	8dq□
u†K#•OqM••#OE#K=†QEaE8q	2iq•K+2KT#□	8dq□
u†K#•O2GTU+OE#K=†QEaE8q	2iq•K+2KT#□	8dq□
Green guide rating		C rated
ygM•Y9TgUOGzMGqQGgOpe□		2=xx9Gpe□
yTG2†E9QOYY5K□		x#KYY6K□
YK9OG2†E9QOYY5K□		x#KYY6K□
YTGc#MKç5K□		x8K□
Security		PAS 24
7 c b Ū [i f U h] c b ' / ' ' Z f U a Y		
Opening		4Q#†TQY#†TcTQE
dMQMGKT#dq□		✓
p•K+GKT#dq□		✓
LGTGKT#dq□		✓
Size limits		
IT(NB9KPB1g2K□		8g
Max frame height*		4q
Max frame height with security features		4q
System features		
Dual colour option		✓
Multi-point locking		✓
Glazing options		4Q9OGQK#
Glazing thickness		4q4q
Sightlines		4q

Key

	Door slides and stacks to the #Oz9□		Door slides and stacks to the GTEk9□		Door opens to the #Oz9□		Door opens to the GTEk9□		Fixed UKQO#□
--	-------------------------------------	--	--------------------------------------	--	-------------------------	--	--------------------------	--	--------------

BSC94SLIM

x

x

mq□

mq□

C rated

npd

x=KYYfK□

x=KYYfK□

xK□

x

4Q#TQOY#TcTQE

x

✓

✓

8g

qq

x

✓

✓

4Q9OGQK#

qqqq

45mm

CAD CROSS SECTIONS

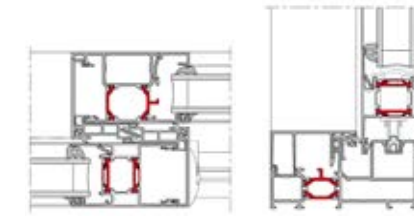

Dual Rail – Cill

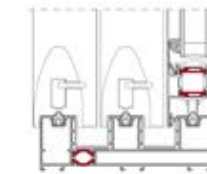

D9KQçKGçD+Tq+TQO4Q9OG+MgC

Luminia

J Y f U b X U

Our customers can now enjoy longer
gi bg\] bY' gYgg] cbgž' Vf] [\hYf' gdUWYg U b X
more late night fresh air while remaining
sheltered and protected at all times.

niG19gBRPLGGK2B)2TNBKIPIRR)TJMKIK2BRnTKMRB
RM5BG)L9KBRRM-KL9g)IMR-TRK)IR,TR,BOMB

And long gone will be the mad panic to get the
M•9çMMGZ•GQT9•GOTQ•DZMG09kOKOK†OQYMUOQ



DF9A - I A' HMD9' %

› nTCOK#YF•içOYTEQY9KTYn•qTQTK
system is inherently strong and near
qKTQ9OQKQgOzGOOLkOYXY9OqK#YM
zOK9•GOY9KOGqK#GOKCYET†TQEXM•9ko
zGOOçMq9MZGKQYzMGq9ko†OGKQçKTQ9M
KQTQY•#K9Oç††TQEYUkgO



MODERN TYPE 3

› w•GqMY9gMQ9OqUMGKGX†OGKQçK
this system boasts slimmer aesthetic
#TQOY9UOGzOg9O&KqU+OMzzMGq
OqçGK†QEZ•Qg9TMQ



ENHANCED TYPE 4

› LkQqMY9GM•Y9†OGKQçKTQ•GGKQEO
9kTY•UOGYT=OççOYTEQNTçOK+TZX•GO
looking for free passage and a brighter
M•9YTçOYUkgOLKQCY9MKç†9TMQK+Y9OO+
reinforcement this system can stretch
KQTqUGOY††OY†&Q9GOY†Q†ç9k†9k
9koY•UUMG9MzMQ+X9+MUMY9Y
VOK+YMMzzOGK††g9MGTKQY9X+OE•99OG
zMG9ko9XUO

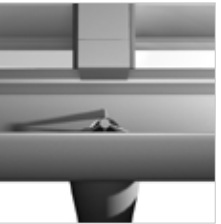

89G = : B' : 95HIF9G

- › Full aluminium system
- › ç†zzOGOQ9çOYTEQM9†TMQY
- › Large span – up to 6m
- › †††ççOQK9OGçGKTQKEOKQç†TQEM
- › Optional sliding doors and walls
- › 5 stylish colours
- › Polycarbonate or glass glazing options

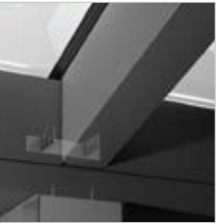

@I A - B = 5' J 9F5B85

G d Y W] Ū WU h] c b g	Type 1	Type 3	Type 4
Thermal breaks	Yes	oM	oM
2Kz9OG††ç9kqç	56	56	56
Concealed drainage	Yes	Yes	Yes
Optio BSC94 integration	Yes	oM	oM
Luminia glass sliding door integration	oM	Yes	Yes
Variable pitch	Yes	Yes	Yes
2MM†EK9††GMEO	Yes	oM	oM
SMY9çOU9kdq	□	□	□
VK#††U+K9Odq	□	□	□
6 Metres span with no central post	oM	oM	Yes

DrYa]ia' j bgi' ūhYX' j YfUbXU' nHmdY' %E' : BD8' nbc' dYfZcfaUbWY' XYW' U†
†DfcXiWh' cb' m' Uj]† ūV' Y' cb' fYeiYgh'†

Finish in style

When it comes to designing aluminium façade systems, we go to great lengths to ensure every part plays its part to perfection. No shortcuts are taken, no corners cut.

We take the exact same approach
+kOQI9gmqOY9MçO†O+MUIQE□
kKGç=KGOfOGXUGMç•g9IY□
designed to not only complement
M•G7XY9OqYI•9Y9GTCTQE+XOQkKQgO□
9kOq9MM□
w•G9GTOç9OY9OçkQç9G•Y9Oç□
hardware range includes suited
kKQç+OY#MgCYkIQEOYGM++OGY□
+MEOXYYOK+YkQç#G•YkOYkGk□
KQçO†OGXUGMç•g9kKY9MUKYYM•G□
zKqM•Y+XY9GTQEOQ99OY9YET9kqMY9□
Y•=ROg9Oç9MmUOGK9TMQK+□
cycles to emulate a lifetime of
9GM•=OzGOOMUOGK9TMQkOQ9kO□
GOK+9OY9IQE#DETQY□
w•GP•K+T9XkYY•GKQgO9OKqY•G†OXY□
O†OGXQ•9O†OGXygGO=O†OGX□
Y•GzKgO9MOQY•GOT9Y#M9k□
YgGK9gkzGOOKQç•U9MygGK9gk□
VOK+YM#D+IO†OYog•GT9XYkM•#ç□
#OKY9KQçKQçQM9KQkYUTGK9TMQ□
49Y#kXk+qMY9O†OGXk#•qIT†q□
M•GkKQç=KGOTygOG9TOçIX9kO□
DOg•GOçXpOYTEQYgKOqO□
wzgM•GYOKççOçY9GOQE9kKQç□
YOG•GT9XYkM•#çQO†OGgmquGMqTYO□
Y9X+OvQçgOG9KITQ+XQO†OGz•Qg9TMQ□
49Y#kXk•GkKQç=KGOUGMç•g9YQM9□
MQ+XTqUGM†OOKYOMzMUOGK9TMQ□
zMGXOKGY9MgmqO#9çO+T†OG□
K9TqO#OYY#MMCKQçQTYk□



T: 01291 639 739
E: info.uk@aluk.com

dBgLYKBRB5AHOB
y#•i5n9c
oO=kM•YOfKGq4Qçr9
Chepstow
oSqp

2OET99OGOç•q:OG
□

aluk.co.uk

Experts in Aluminium

ALUK[®]